

# Signature

## DRY DISPLAY – DLNH

MODELS: DLNH 5138, DLNH 5146, DLNH 5158, DLNH 5176, DLNH 5192

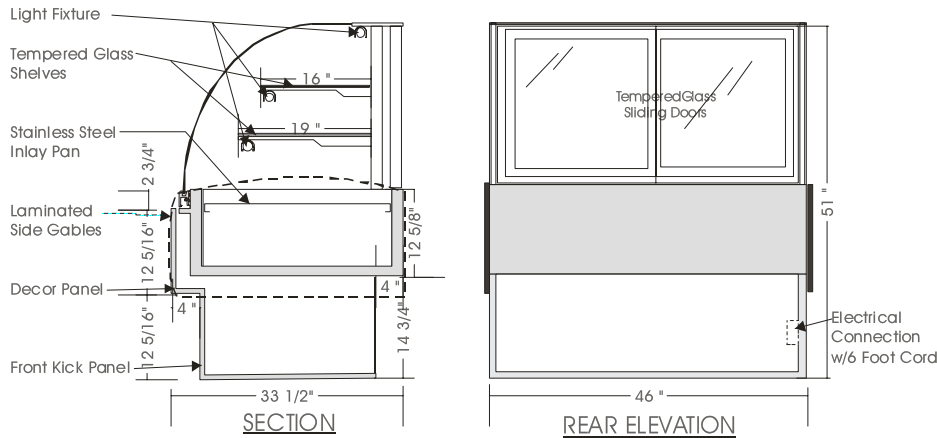

### SPECIFICATIONS

MODEL	DIMENSIONS	ELECTRICAL	SHIPPING WT.
DLNH 5138	38"L.X33½"D.X51"H.	115V/1/60HZ/1.5 AMP	300 lb.
DLNH 5146	46"L.X33½"D.X51"H.	115V/1/60HZ/1.5 AMP	360 lb.
DLNH 5158	58"L.X33½"D.X51"H.	115V/1/60HZ/2.0 AMP	430 lb.
DLNH 5176	76"L.X33½"D.X51"H.	115V/1/60HZ/2.5 AMP	520 lb.
DLNH 5192	92"L.X33½"D.X51"H.	115V/1/60HZ/3.0 AMP	600 lb.

*Note: Add ¼" each side for side gables.*

#### STANDARD FEATURES

1. Top light.
2. Shelf lights.
3. Tempered curved front glass, tilt forward and removable.
4. Tempered side glass.
5. Stainless steel interior.
6. Clear satin anodized aluminum hinge and framework.
7. Exterior & interior laminate finish: Black.

#### OPTIONS

1. Plastic laminate exterior finish of choice.
2. Powder coated aluminum hinge and framework.
3. Custom anodized colour hinge and framework.
4. Custom units on request.

\*Due to constant Improvements, specifications are subject to change without notice.



## Canadian Display Systems Inc.

177 Westcreek Drive, Woodbridge, Ontario L4L 9N6  
 Ph: 905-265-7888, 1-800-895-5862 Fax: 905-265-7692  
 email [cds1@on.aibn.com](mailto:cds1@on.aibn.com)  
[www.canadiandisplayystems.com](http://www.canadiandisplayystems.com)