

Signature

DRY CASE W/DRAWER – DLNP-D

MODELS: DLNP-D 5138, DLNP-D 5146, DLNP-D 5158, DLNP-D 5176, DLNP-D 5192

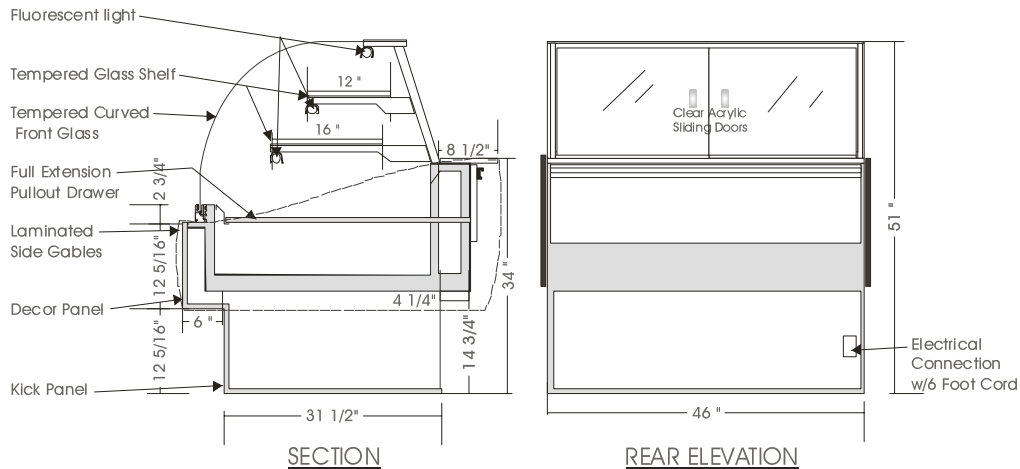

SPECIFICATIONS

MODEL	DIMENSIONS	ELECTRICAL	SHIPPING WT.
DLNP-D 5138	38"L.X45 $\frac{3}{4}$ "D.X51"H.	115V/1/60HZ/1.5 AMP	325 lb.
DLNP-D 5146	46"L.X45 $\frac{3}{4}$ "D.X51"H.	115V/1/60HZ/1.5 AMP	390 lb.
DLNP-D 5158	58"L.X45 $\frac{3}{4}$ "D.X51"H.	115V/1/60HZ/2.0 AMP	450 lb.
DLNP-D 5176	76"L.X45 $\frac{3}{4}$ "D.X51"H.	115V/1/60HZ/2.5 AMP	560 lb.
DLNP-D 5192	92"L.X45 $\frac{3}{4}$ "D.X51"H.	115V/1/60HZ/3.0 AMP	680 lb.

Note: Add $\frac{3}{4}$ " each side for side gables.

STANDARD FEATURES

1. Top light.
2. Shelf lights.
3. Tempered curved front glass, tilt forward and removable.
4. Full extension pullout drawer – laminate covered black.
5. Clear satin anodized aluminum hinge and framework.
6. Exterior & interior laminate finish: Black.
7. Laminate covered side gables.

OPTIONS

1. Plastic laminate exterior finish of choice.
2. Powder coated aluminum hinge and framework.
3. Custom anodized colour hinge and framework.
4. Custom units on request.

*Due to constant improvements, specifications are subject to change without notice.



Canadian Display Systems Inc.

177 Westcreek Drive, Woodbridge, Ontario LNL 9N6
Ph: 905-265-7888, 1-800-895-5862 Fax: 905-265-7692

email cds1@on.aibn.com
www.canadiandisplayssystem.com