

Infinity

HOT FOOD TABLE – IHM

MODELS: IHM 5240-2, IHM 5248-3, IHM 5260-4, IHM 5278-5

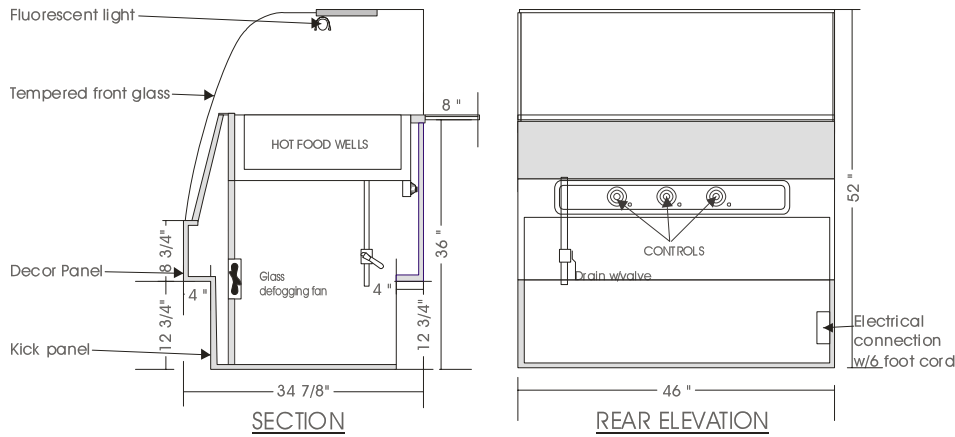

SPECIFICATIONS

MODEL	DIMENSIONS	WELLS	ELECTRICAL WELLS	ELECTRICAL LIGHTS	SHIPPING WT.
IHM 5240-2	40"L.X34 ⁷ / ₈ "D.X52"H.	2	208V/1/60 HZ/11.9 AMP	115/1/60 HZ/1.0 AMP	420 lb.
IHM 5248-3	48"L.X34 ⁷ / ₈ "D.X52"H.	3	208V/1/60 HZ/17.9 AMP	115/1/60 HZ/1.0 AMP	500 lb.
IHM 5260-4	60"L.X34 ⁷ / ₈ "D.X52"H.	4	208V/1/60 HZ/23.8 AMP	115/1/60 HZ/1.0 AMP	570 lb.
IHM 5278-5	78"L.X34 ⁷ / ₈ "D.X52"H.	5	208V/1/60 HZ/29.8 AMP	115/1/60 HZ/1.0 AMP	760 lb.

Permanent electrical connection for hot wells. Cord & Plug for Light and ventilation Fan.

STANDARD FEATURES

1. Top light.
2. Fixed tempered curved front glass.
3. Exterior & interior laminate finish: Black.
4. Solid sides.

OPTIONS

1. Plastic laminate exterior finish of choice.
2. Custom units upon request.

*Due to constant improvements, specifications are subject to change without notice.



Canadian Display Systems Inc.

177 Westcreek Drive, Woodbridge, Ontario L4L 9N6
Ph: 905-265-7888, 1-800-895-5862 Fax: 905-265-7692

email cds1@on.aibn.com

www.canadiandisplayssystems.com