

Infinity

DRY DISPLAY CASE – GLASS ENDS – IDG

MODELS: IDG 5238, IDG 5246, IDG 5258, IDG 5276, IDG 5292

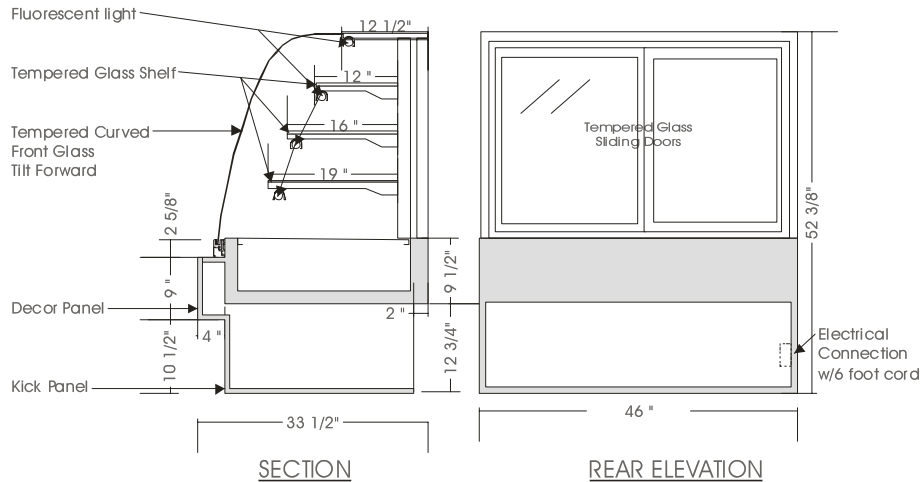

SPECIFICATIONS

MODEL	DIMENSIONS	ELECTRICAL	SHIPPING WT.
IDG 5238	38"L.X33 1/2"D.X52 3/8"H.	115V/1/60 HZ/1.5 AMP	350 lbs.
IDG 5246	46"L.X33 1/2"D.X52 3/8"H.	115V/1/60 HZ/1.5 AMP	425 lbs.
IDG 5258	58"L.X33 1/2"D.X52 3/8"H.	115V/1/60 HZ/2.0 AMP	610 lbs.
IDG 5276	76"L.X33 1/2"D.X52 3/8"H.	115V/1/60 HZ/2.5 AMP	550 lbs
IDG 5292	92"L.X33 1/2"D.X52 3/8"H.	115V/1/60 HZ/3.0 AMP	650 lbs

STANDARD FEATURES

1. Top light and shelf lights.
2. Tempered curved front glass, tilt forward and removable.
3. Front glass defogging system.
4. Stainless steel interior.
5. Clear satin anodized aluminum hinge and framework.
6. Exterior & interior laminate finish: Black.

OPTIONS

1. Plastic laminate exterior finish of choice.
2. Powder coated aluminum hinge and framework.
3. Tempered glass shelves.
4. Custom units on request.
5. Laminate covered side gables.

*Due to constant improvements, specifications are subject to change without notice.



Canadian Display Systems Inc.

177 Westcreek Drive, Woodbridge, Ontario L4L 9N6
Ph: 905-265-7888, 1-800-895-5862 Fax: 905-265-7692

email [cgs1@on.aibn.com](mailto:cds1@on.aibn.com)
www.canadiandisplayystems.com