

PROJECT:

QUANTITY:

ITEM: NO:

*Infinity***COLD FOOD TABLE – ICD**

MODELS: ICD 5538, ICD 5546, ICD 5558, ICD 5576, ICD 5592

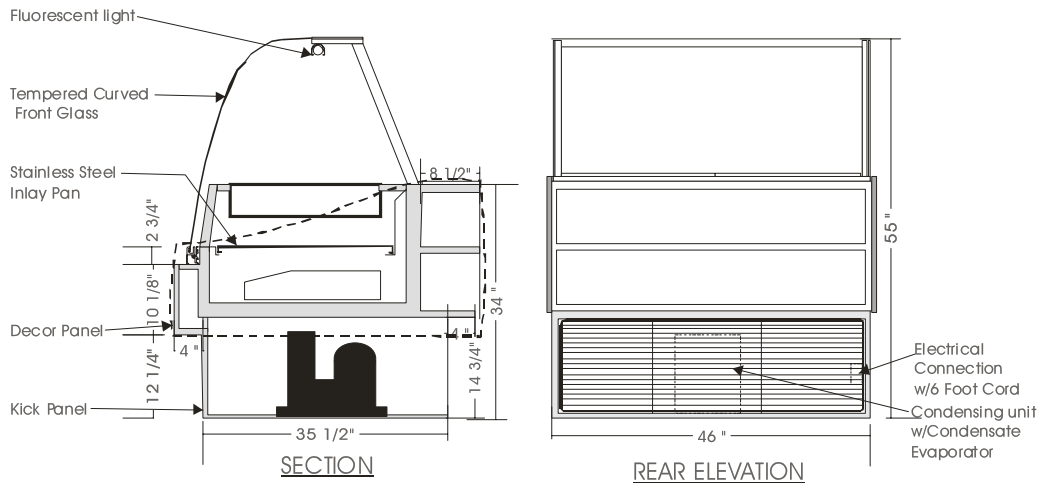
**SPECIFICATIONS**

MODEL	DIMENSIONS	COMPRESSOR	ELECTRICAL	SHIPPING WT.
ICD 5538	38"L.X44"D.X55"H.	¼ H.P.	115V/1/60 HZ/ 9.0 AMP	400 lb.
ICD 5546	46"L.X44"D.X55"H.	⅓ H.P.	115V/1/60 HZ/10.0 AMP	460 lb.
ICD 5558	58"L.X44"D.X55"H.	⅓ H.P.	115V/1/60 HZ/10.0 AMP	525 lb.
ICD 5576	76"L.X44"D.X55"H.	½ H.P.	115V/1/60 HZ/12.0 AMP	650 lb.
ICD 5592	92"L.X44"D.X55"H.	½ H.P.	115V/1/60 HZ/13.0 AMP	890 lb.

Note: Add ¼" each side for side gables.

STANDARD FEATURES

1. Top light.
2. Sani board work surface.
3. Tempered tilt forward glass front, removable.
4. Tempered side glass, removable.
5. Stainless steel interior.
6. Clear satin anodized aluminum hinge and framework.
7. Interior & exterior laminate finish: Black
8. Self contained air cooled compressor w/hot gas condensate evaporator pan.
9. Laminate covered side gables.

OPTIONS

1. Plastic laminate exterior finish of choice.
2. Powder coated aluminum hinge and framework.
3. Custom anodized colour hinge and framework.
4. Custom unit on request.
5. Additional glass shelves.
6. Remote condensing unit.

Operating temperature of 2° to 4° Celsius (37° to 40°F.) under normal store conditions of 24° Celsius (75°F.) with 50% relative humidity.

Condensation on glass may occur under hot & humid conditions.

Product entering the display case must be 4° Celsius (40°F.) or lower.

*Due to constant improvements, specifications are subject to change without notice.

**Canadian Display Systems Inc.**

177 Westcreek Drive, Woodbridge, Ontario L4L 9N6
 Ph: 905-265-7888, 1-800-895-5862 Fax: 905-265-7692
 email cds1@on.aibn.com
www.canadiandisplayssystems.com