

# Infinity

## HOT FOOD TABLE – IHD

MODELS: IHD 5538, IHD 5546, IHD 5558, IHD 5576, IHD 5592

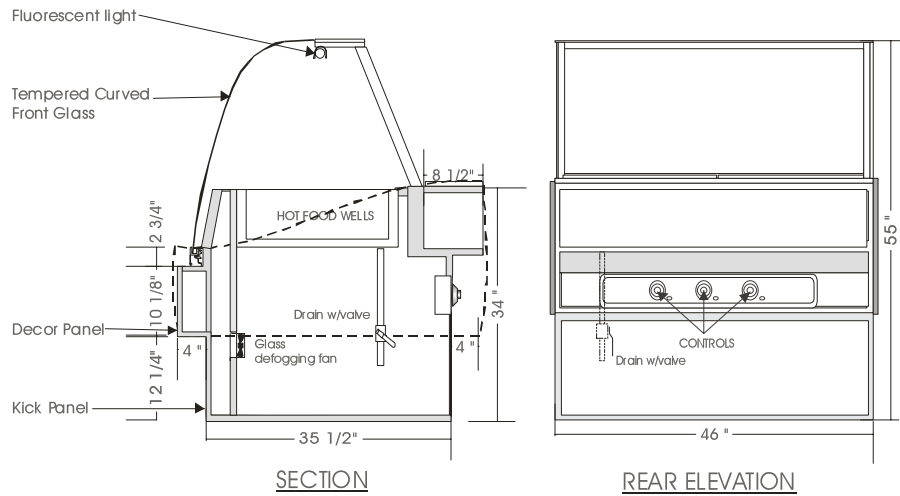

### SPECIFICATIONS

MODEL	DIMENSIONS	WELLS	ELECTRICAL (WELLS)	ELECTRICAL (LIGHT/FAN)	SHIPPING WT.
IHD 5538	38"L.X44"D.X55"H.	2 WELLS	208V/1/60HZ/11.9 Amp	115V/1/60HZ/1.5 Amp	360 lb.
IHD 5546	46"L.X44"D.X55"H.	3 WELLS	208V/1/60HZ/17.9 Amp	115V/1/60HZ/1.8 Amp	460 lb.
IHD 5558	58"L.X44"D.X55"H.	4 WELLS	208V/1/60HZ/23.8 Amp	115V/1/60HZ/2.0 Amp	530 lb.
IHD 5576	76"L.X44"D.X55"H.	5 WELLS	208V/1/60HZ/29.8 Amp	115V/1/60HZ/2.5 Amp	650 lb.
IHD 5592	92"L.X44"D.X55"H.	6 WELLS	208V/1/60HZ/35.8 Amp	115V/1/60HZ/3.0 Amp	890 lb.

*Note: Add 3/4" each side for side gables.*

#### STANDARD FEATURES

1. Top light.
2. Sani board work surface.
3. Tempered tilt forward glass front, removable.
4. Tempered glass side, removable.
5. Stainless steel interior.
6. Clear satin anodized aluminum hinge and framework.
7. Exterior & interior laminate finish: Black.
8. Laminate covered side gables.

#### OPTIONS

1. Plastic laminate exterior finish of choice.
2. Powder coated aluminum hinge and framework.
3. Custom anodized colour hinge and framework.
4. Custom units on request.
5. Additional glass shelves w/lights.

\*Due to constant improvements, specifications are subject to change without notice.



## Canadian Display Systems Inc.

177 Westcreek Drive, Woodbridge, Ontario L4L 9N6  
Ph: 905-265-7888, 1-800-895-5862 Fax: 905-265-7692

email [cds1@on.aibn.com](mailto:cds1@on.aibn.com)

[www.canadiandisplayystems.com](http://www.canadiandisplayystems.com)