

# Grab And Go

## REF. SELF SERVE / DRY SERVE MERCHANDISER – RSDS 67

MODELS: RSDS 6738, RSDS 6748, RSDS 6760

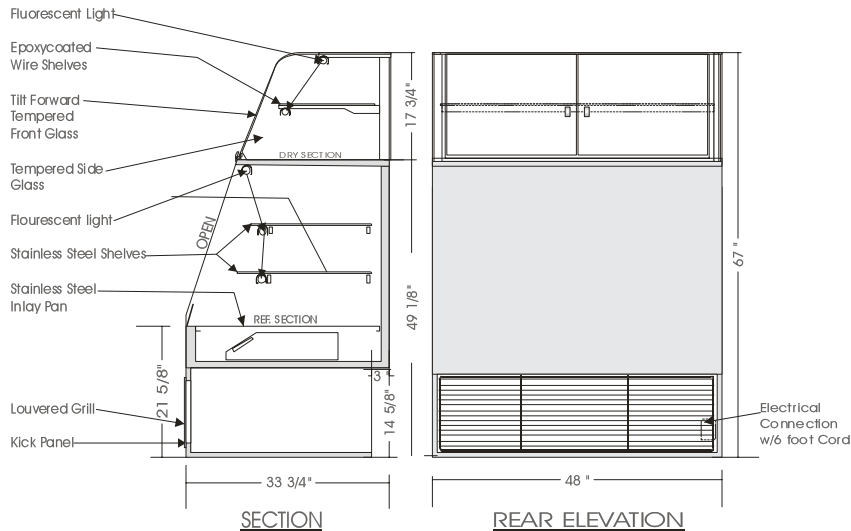

### SPECIFICATIONS

MODEL	DIMENSIONS	UNIT	ELECTRICAL(DUAL VOLTAGE 1 Ph/60Hz)			SHIPPING
			H.P.	COND. UNIT	LIGHTS	
RSDS 6738	38"L.X33 3/4"D.X67"H.	1/2	115V/1/60 HZ /16.0 AMPS	115V/2.0 AMPS	115V/8.3 AMPS	450 lb.
RSDS 6748	48"L.X33 3/4"D.X67"H.	3/4	230V/1/60 HZ/ 8.0 AMPS	115V/2.0 AMPS	115V/8.3 AMPS	510 lb.
RSDS 6760	60"L.X33 3/4"D.X67"H.	3/4	230V/1/60 HZ/ 9.4 AMPS	115V/2.5 AMPS	115V/8.3 AMPS	590 lb.

*Direct connection to Condensing unit, Light & Evaporator pan (Optional).  
 Floor drain highly recommended for these units. Front air intake ventilation grill.*

#### STANDARD FEATURES

1. Top light.
2. Tempered side glass, removable.
3. Tempered curved front glass tilt forward and removable.
4. Clear satin anodized aluminum hinge & framework.
5. Self contained air cooled compressor
6. Exterior & interior laminate finish: Black.

#### OPTIONS

1. Additional shelf lights.
2. Plastic laminate exterior finish of choice.
3. Powder coated or colour anodized hinge & framework.
4. Bumper rails – specify colour & location.
5. Remote condensing unit.
6. Evaporator condensate pan.

*Operating temperature of 2° to 4° Celsius (37° to 40°F.) under normal store conditions of 24° Celsius (75°F.) with 50% relative humidity.  
 Condensation on glass may occur under hot & humid conditions.  
 Product entering the display case must be 4° Celsius (40°F.) or lower.*

\*Due to constant improvements, specifications are subject to change without notice.



## Canadian Display Systems Inc.

177 Westcreek Drive, Woodbridge, Ontario L4L 9N6  
 Ph: 905-265-7888, 1-800-895-5862 Fax: 905-265-7692

email [cds1@on.aibn.com](mailto:cds1@on.aibn.com)  
[www.canadalanddisplayssystems.com](http://www.canadalanddisplayssystems.com)