

Grab And Go

UPRIGHT SELF SERVE REFRIGERATED MERCHANDISER – RSS 84

MODELS: RSS 8436, RSS 8448, RSS 8460, RSS 8472, RSS 8496

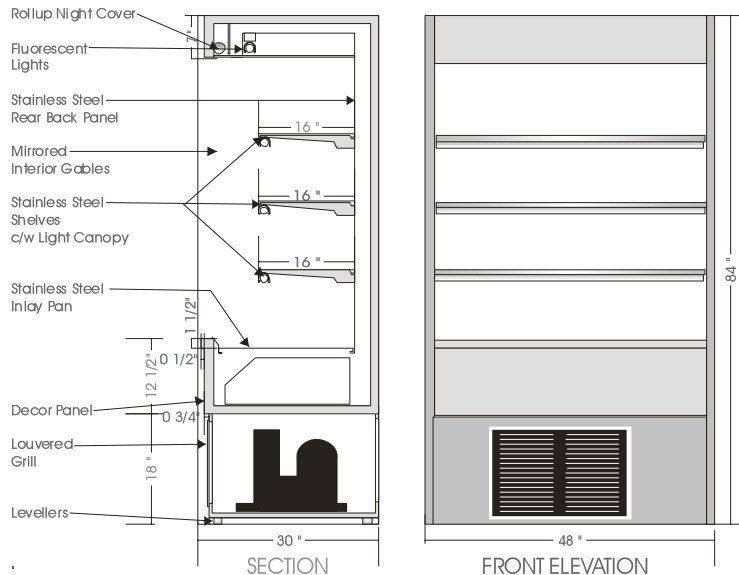

SPECIFICATIONS

MODEL	DIMENSIONS	UNIT H.P.	ELECTRICAL (DUAL VOLTAGE 1 PH/60 HZ)			SHIPPING WT.
			COND. UNIT	LIGHTS	EVAPORATOR PAN	
RSS 8436	36"L.X 30"D.X84"H.	3/4	230V/ 8.0 AMP	115/2.0 AMP	115/08.3 AMP	490 lb.
RSS 8448	48"L.X 30"D.X84"H.	3/4	230V/ 9.4 AMP	115/2.5 AMP	115/08.3 AMP	590 lb.
RSS 8460	60"L.X 30"D.X84"H.	1 1/4	230V/14.9 AMP	115/3.0 AMP	115/08.3 AMP	690 lb.
RSS 8472	72"L.X 30"D.X84"H.	1 1/2	230V/17.4 AMP	115/3.5 AMP	115/08.3 AMP	790 lb.
RSS 8496	96"L.X 30"D.X84"H.	1 1/2	230V/17.4 AMP	115/6.0 AMP	115/12.4 AMP	990 lb.

Direct connection to Condensing unit, Light & Evaporator pan (Optional).

Floor drain highly recommended for these units. Air flow front to back. Allow 6" space between wall & unit for air circulation.

STANDARD FEATURES

1. Top light and three shelf lights
2. Three adjustable stainless steel shelves.
3. Exterior & Interior lamination finish: Black.
4. Stainless steel deck and perforated back.
5. Mirrored interior gables.
6. Self contained condensing unit.

OPTIONS

1. Plastic lamination exterior finish of choice.
2. Powder coated finish in display area.
3. Bumper rails - Specify colour and location.
4. Condensate evaporator pan.
5. Tempered glass shelves.
6. Clear acrylic security panels
7. Remote compressor installation.
8. Rear access doors.

Operating temperature of 2° to 4° Celsius (37° to 40°F.) under normal store conditions of 24° Celsius (75°F.) with 50% relative humidity. Condensation on glass may occur under hot & humid conditions.

Product entering the display case must be 4° Celsius (40°F.) or lower.

*Due to constant improvements, specifications are subject to change without notice.



Canadian Display Systems Inc.

177 Westcreek Drive, Woodbridge, Ontario L4L 9N6
 Ph: 905-265-7888, 1-800-895-5862 Fax: 905-265-7692
 email cds1@on.aibn.com
www.canadiandisplayssystems.com