

Grab And Go

UPRIGHT SELF SERVE REFRIGERATED MERCHANDISER – RSS 78

MODELS: RSS 7836, RSS 7848, RSS 7860, RSS 7872, RSS 7896

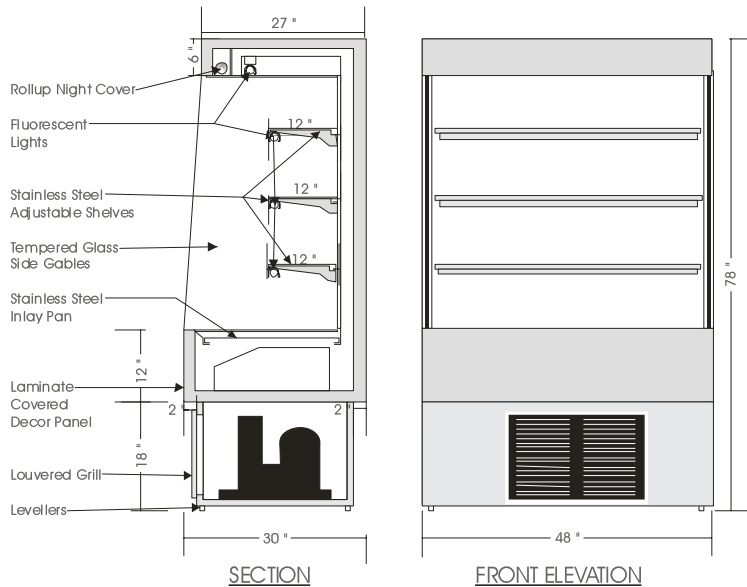

SPECIFICATIONS

MODEL	DIMENSIONS	UNIT H.P.	ELECTRICAL(DUAL VOLTAGE) 1 PH/60 HZ			SHIPPING WT.
			COND. UNIT	LIGHTS	EVAPORATOR(OPT.)	
RSS 7836	36"L.X30"D.X78"H.	¾	230V/08.0 AMP	115V/1.5 AMP	115V/8.3 AMP	490 lb.
RSS 7848	48"L.X30"D.X78"H.	¾	230V/09.4 AMP	115V/2.0 AMP	115V/8.3 AMP	590 lb.
RSS 7860	60"L.X30"D.X78"H.	1¼	230V/14.9 AMP	115V/2.5 AMP	115V/8.3 AMP	769 lb.
RSS 7872	72"L.X30"D.X78"H.	1½	230V/17.4 AMP	115V/3.0 AMP	115V/8.3 AMP	790 lb.
RSS 7896	96"L.X30"D.X78"H.	1½	230V/17.4 AMP	115V/5.0 AMP	115V/8.3 AMP	990 lb.

Direct connection to Condensing unit, Light & Evaporator pan (Optional).

Floor drain highly recommended for these units. Front air intake ventilation grill.

Allow 6" space between wall & unit for air circulation.

STANDARD FEATURES

1. Top light and three shelf lights.
2. Three adjustable stainless steel shelves.
3. Pull down night cover.
4. Exterior & interior laminate finish: Black.
5. Stainless steel deck and perforated back.
6. Self contained condensing unit.

OPTIONS

1. Plastic laminate exterior finish of choice.
2. Powder coated finish in display area.
3. Bumper rails – specify colour and location.
4. Condensate evaporator pan.
5. Rear access doors.
6. Remote condensing unit.

Operating temperature of 2° to 4° Celsius (37° to 40°F.) under normal store conditions of 24° Celsius (75°F.) with 50% relative humidity.

Condensation on glass may occur under hot & humid conditions.

Product entering the display case must be 4° Celsius (40°F.) or lower.

**Due to constant improvements, specifications are subject to change without notice.*



Canadian Display Systems Inc.

177 Westcreek Drive, Woodbridge, Ontario L9L 9N6
Ph: 905-265-7888, 1-800-895-5862 Fax: 905-265-7692
email cds1@on.aibn.com

www.canadiandisplayssystems.com