

Eurostyle

DRY CANDY CASE – CCD

MODELS: CCD 4840, CCD 4848, CCD 4860, CCD 4869, CCD 4878, CCD 4894

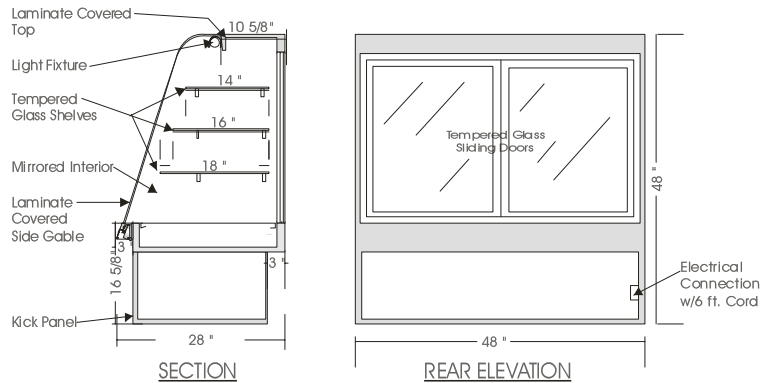

SPECIFICATIONS

MODEL	DIMENSIONS	ELECTRICAL	SHIPPING WT.
CCD 4840	40"L.X28"D.X48"H.	115V/1/60HZ/ 1.0 AMP	300 lb.
CCD 4848	48"L.X28"D.X48"H.	115V/1/60HZ/ 1.0 AMP	360 lb.
CCD 4860	60"L.X28"D.X48"H.	115V/1/60HZ/ 1.0 AMP	420 lb.
CCD 4869	69"L.X28"D.X48"H.	115V/1/60HZ/ 1.0 AMP	460 lb.
CCD 4878	78"L.X28"D.X48"H.	115V/1/60HZ/ 1.5 AMP	510 lb.
CCD 4894	94"L.X28"D.X48"H.	115V/1/60HZ/ 2.0 AMP	650 lb.

STANDARD FEATURES

1. Top light.
2. Solid sides w/mirrored interior gables.
3. Tempered curved front glass, tilt forward & removable.
4. Tempered glass shelves.
5. Clear satin anodized aluminum hinge.
6. Exterior & interior laminate finish: Black.

OPTIONS

1. Shelf lights.
2. Plastic laminate exterior finish of choice.
3. Powder coated or colour anodized hinge.
4. Custom units on request.

*Due to constant improvements, specifications are subject to change without notice.



Canadian Display Systems Inc.

177 West Creek Drive, Woodbridge, Ontario L4L 9N6
 Ph: 905-265-7888, 1-800-895-5862 Fax: 905-265-7692
 email [cgs1@on.aibn.com](mailto:cds1@on.aibn.com)
www.canadiandisplayssystems.com