

Eurostyle

REFRIGERATED DISPLAY – RPDW-F (Forced air)

MODELS: RPDW-F 4840, RPDW-F 4848, RPDW-F 4860, RPDW-F 4869, RPDW-F 5078, RPDW-F 5094

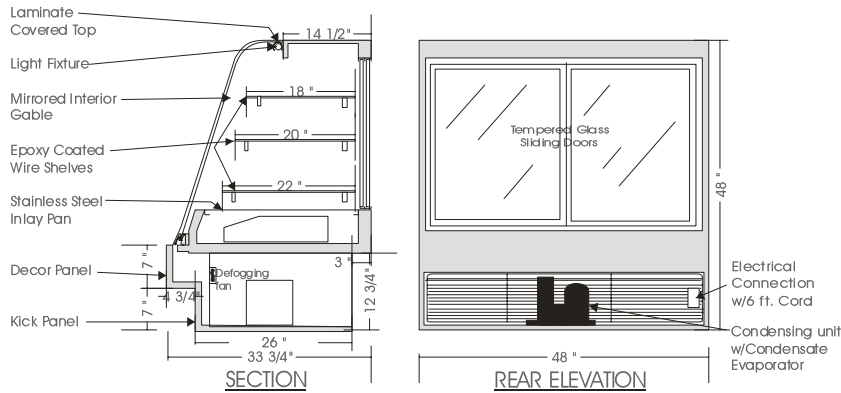

SPECIFICATIONS

MODEL	DIMENSIONS	COMPRESSOR	ELECTRICAL	SHIPPING WT.
RPDW-F 4840	40"L.X34"D.X48"H.	1/3 H.P.	115V/1/60HZ/ 9.0 AMP	400 lb.
RPDW-F 4848	48"L.X34"D.X48"H.	1/3 H.P.	115V/1/60HZ/ 9.0 AMP	480 lb.
RPDW-F 4860	60"L.X34"D.X48"H.	1/2 H.P.	115V/1/60HZ/12.0 AMP	550 lb.
RPDW-F 4869	69"L.X34"D.X48"H.	1/2 H.P.	115V/1/60HZ/12.5 AMP	625 lb.
RPDW-F 5078**	78"L.X34"D.X50"H.	1/2 H.P.	115V/1/60HZ/13.0 AMP	740 lb.
RPDW-F 5094**	94"L.X34"D.X50"H.	3/4 H.P.	115V/1/60HZ/16.0 AMP	860 lb.

** Height increased to 50" to accommodate condensing unit. 48" HT available with remote condensing unit only.

STANDARD FEATURES

1. Top light.
2. Solid sides w/mirrored interior gables.
3. Tempered curved front glass tilt forward & removable.
4. White epoxy coated wire shelves.
5. Clear satin anodized aluminum hinge.
6. Exterior & interior laminate finish: Black.
7. Self contained compressor w/hot gas condensate evaporator pan.
8. Front glass defogging system.

OPTIONS

1. Shelf lights.
2. Powder coated or colour anodized hinge.
3. Plastic laminate exterior finish of choice
4. Custom units on request.
5. Remote condensing unit.
6. Tempered glass shelves.

Operating temperature of 2° to 4° Celsius (37° to 40° F.) under normal store conditions of 24° Celsius (75° F.) with 50% relative humidity.

Condensation on glass may occur under hot & humid conditions.

Product entering the display case must be 4° Celsius (40° F.) or lower.

*Due to constant improvements, specifications are subject to change without notice.



Canadian Display Systems Inc.

177 Westcreek Drive, Woodbridge, Ontario L4L 9N6
 Ph: 905-265-7888, 1-800-895-5862 Fax: 905-265-7692
 email [cgs1@on.aibn.com](mailto:cds1@on.aibn.com)
www.canadiandisplayssystems.com