

# Eurostyle

## BUN CASE – NPDW-B

MODELS: NPDW 4848-B, NPDW 4860-B, NPDW 4878-B, NPDW 4894-B

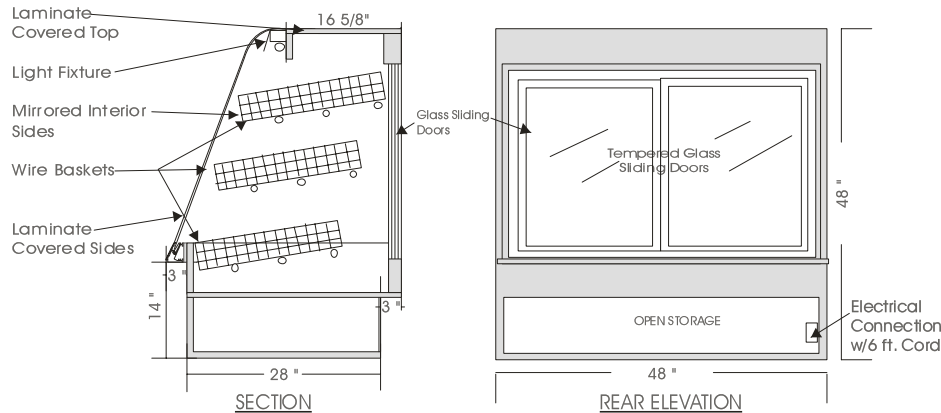

### SPECIFICATIONS

MODEL	DIMENSIONS	ELECTRICAL	SHIPPING WT.
NPDW 4848-B	48"L.X34"D.X48"H.	115V/ 1/60HZ/01.0 AMP	360lb.
NPDW 4860-B	60"L.X34"D.X48"H.	115V/ 1/60HZ/01.0 AMP	420lb.
NPDW 4878-B	78"L.X34"D.X48"H.	115V/ 1/60HZ/01.5 AMP	520lb.
NPDW 4894-B	94"L.X34"D.X48"H.	115V/ 1/60HZ/02.0 AMP	600lb.

#### STANDARD FEATURES

1. Top light.
2. Solid sides w/mirrored interior gables.
3. Tempered curved front glass, tilt forward & removable.
4. White epoxy coated wire shelves.
5. Clear satin anodized aluminum hinge.
6. Exterior & interior laminate finish: Black.

#### OPTIONS

1. Shelf lights.
2. Plastic laminate exterior finish of choice.
3. Powder coated or colour anodized hinge.
4. Custom units on request.

\*Due to constant improvements, specifications are subject to change without notice.



## Canadian Display Systems Inc.

177 Westcreek Drive, Woodbridge, Ontario L4L 9N6  
Ph: 905-265-7888, 1-800-895-5862 Fax: 905-265-7692

email [cds1@on.aibn.com](mailto:cds1@on.aibn.com)

[www.canadiandisplayssystems.com](http://www.canadiandisplayssystems.com)