

Eurostyle

REF./DRY DUAL CASE – RRDF

MODELS: RRDF 4846, RRDF 4858, RRDF 4876, RRDF 4892

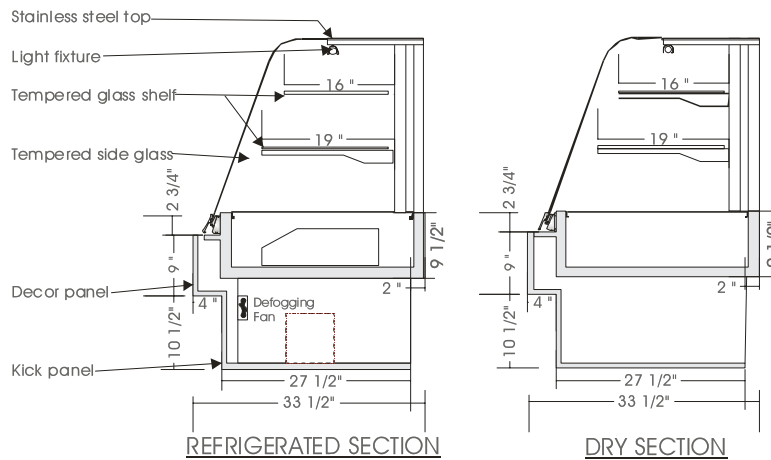

SPECIFICATIONS

MODEL	DIMENSIONS	COMPRESSOR	ELECTRICAL	SHIPPING WT.
RRDF 4846	46"L.X33 1/2"D.X48"H.	1/4 H.P.	115V/1/60 HZ/ 9.5 AMP	480 lb.
RRDF 4858	58"L.X33 1/2"D.X48"H.	1/3 H.P.	115V/1/60 HZ/10.0 AMP	550 lb.
RRDF 4876	76"L.X33 1/2"D.X48"H.	1/3 H.P.	115V/1/60 HZ/10.5 AMP	640 lb.
RRDF 4892	92"L.X33 1/2"D.X48"H.	1/3 H.P.	115V/1/60 HZ/11.0 AMP	740 lb.

STANDARD FEATURES

1. Top light
2. Tempered side glass, removable.
3. Tempered curved front glass, tilt forward & removable.
4. Clear anodized aluminum hinge and framework.
5. Self contained air cooled compressor w/hot gas condensate evaporator.
6. Exterior & interior laminate finish: Black.

OPTIONS

1. Additional shelf lights.
2. Plastic laminate exterior finish of choice.
3. Powder coated or colour anodized hinge and framework.
4. Remote condensing unit.
5. Laminate covered side gables.

Operating temperature of 2° to 4° Celsius (37° to 40° F.) under normal store conditions of 24° Celsius (75° F.) with 50% relative humidity. Condensation on glass may occur under hot & humid conditions.

Product entering the display case must be 4° Celsius (40° F.) or lower.

*Due to constant improvements, specifications are subject to change without notice.



Canadian Display Systems Inc.

177 West Creek Drive, Woodbridge, Ontario L4L 9N6
905-265-7888 905-265-7692 fax 1-800-895-5862

email cds1@on.aibn.com

www.canadiandisplaysystems.com