

Eurostyle

REFRIGERATED DISPLAY – RPDF

MODELS: RPDF 4838, RPDF 4846, RPDF 4858, RPDF 4876, RPDF 4892

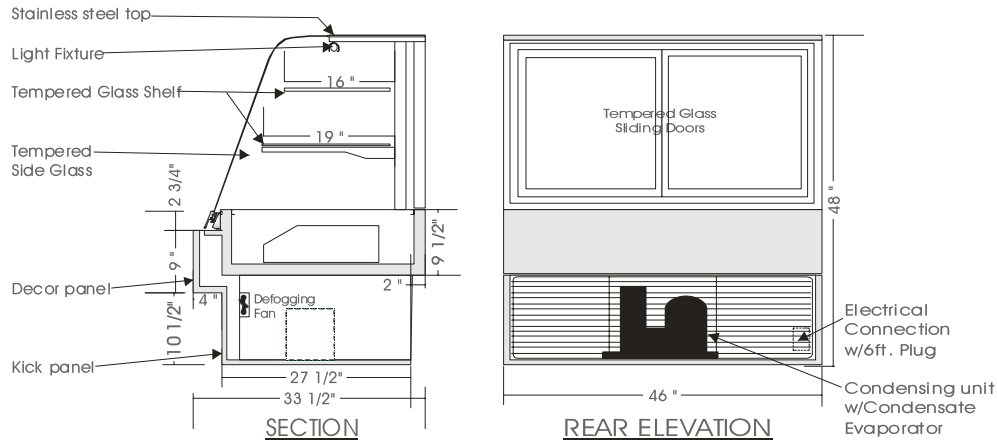

SPECIFICATIONS

MODEL	DIMENSIONS	COMPRESSOR	ELECTRICAL	SHIPPING WT.
RPDF 4838	38"L.X33 1/2"D.X48"H.	1/3 H.P.	115V/1/60 HZ/ 9.0 AMP	400 lb.
RPDF 4846	46"L.X33 1/2"D.X48"H.	1/3 H.P.	115V/1/60 HZ/10.0 AMP	480 lb.
RPDF 4858	58"L.X33 1/2"D.X48"H.	1/2 H.P.	115V/1/60 HZ/12.0 AMP	550 lb.
RPDF 4876	76"L.X33 1/2"D.X48"H.	1/2 H.P.	115V/1/60 HZ/12.5 AMP	640 lb.
RPDF 4892	92"L.X33 1/2"D.X48"H.	3/4 H.P.	115V/1/60 HZ/16.0 AMP	790 lb.

STANDARD FEATURES

1. Top light.
2. Tempered side glass, removable.
3. Tempered curved front glass, tilt forward & removable.
4. Clear satin anodized aluminum hinge and framework.
5. Self contained air cooled compressor /hot gas condensate evaporator.
6. Exterior & interior laminate finish: Black.
7. Front glass defogging system.

OPTIONS

1. Additional shelf lights.
2. Plastic laminate exterior finish of choice.
3. Powder coated or colour anodized hinge and framework.
4. Laminate covered side gables.
5. Remote condensing unit.

Operating temperature of 2° to 4° Celsius (37° to 40° F.) under normal store conditions of 24° Celsius (75° F.) with 50% relative humidity. Condensation on glass may occur under hot & humid conditions.

Product entering the display case must be 4° Celsius (40° F.) or lower.

*Due to constant improvements, specifications are subject to change without notice.



Canadian Display Systems Inc.

177 Westcreek Drive, Woodbridge, Ontario L4L 9N6
Ph: 905-265-7888, 1-800-895-5862 Fax: 905-265-7692

email cds1@on.aibn.com

www.canadiandisplayystems.com