

Eurostyle

HOT FOOD TABLE – NHD

MODELS: NHD 5338, NHD 5346, NHD 5358, NHD 5376, NHD 5392

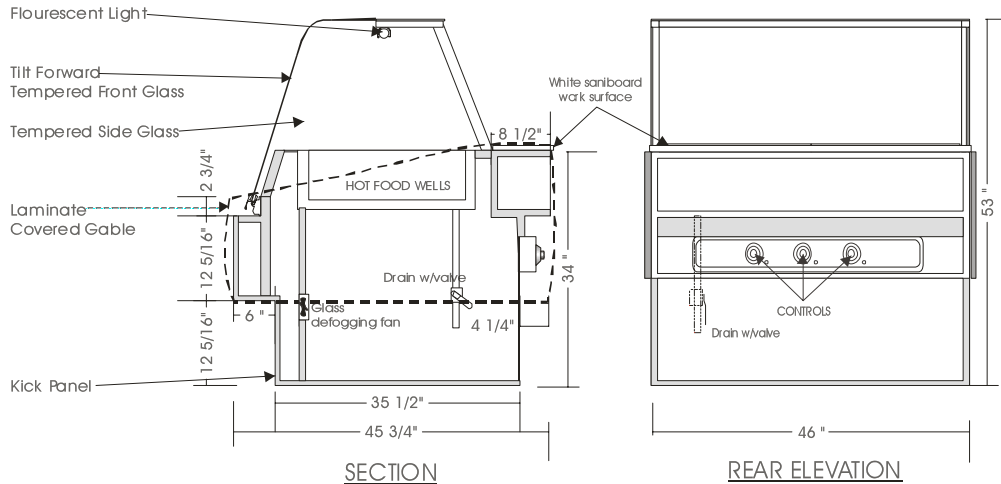

SPECIFICATIONS

MODEL	DIMENSIONS	WELLS	ELECTRICAL (WELLS)	ELECTRICAL (LIGHT/FAN)	SHIPPING WT.
NHD 5338	38"L.X45 ³ / ₄ "D.X53"H.	2 WELLS	208V/1/60HZ/11.9 Amp	115V/1/60HZ/1.5 Amp	360 lb.
NHD 5346	46"L.X45 ³ / ₄ "D.X53"H.	3 WELLS	208V/1/60HZ/17.9 Amp	115V/1/60HZ/1.8 Amp	460 lb.
NHD 5358	58"L.X45 ³ / ₄ "D.X53"H.	4 WELLS	208V/1/60HZ/23.8 Amp	115V/1/60HZ/2.0 Amp	530 lb.
NHD 5376	76"L.X45 ³ / ₄ "D.X53"H.	5 WELLS	208V/1/60HZ/29.8 Amp	115V/1/60HZ/2.5 Amp	650 lb.
NHD 5392	92"L.X45 ³ / ₄ "D.X53"H.	6 WELLS	208V/1/60HZ/35.8 Amp	115V/1/60HZ/3.0 Amp	890 lb.

Note: Add 3/4" each side for side gables.

STANDARD FEARES

1. Top light.
2. Sani board work surface.
3. Tempered tilt forward glass front, removable.
4. Tempered glass side, removable.
5. Stainless steel interior.
6. Clear satin anodized aluminum hinge and framework.
7. Exterior & interior laminate finish: Black.
8. Laminate covered side gables.

OPTIONS

1. Plastic laminate exterior finish of choice.
2. Powder coated aluminum hinge and framework.
3. Custom anodized colour hinge and framework.
4. Custom units on request.
5. Additional glass shelves w/lights.

*Due to constant improvements, specifications are subject to change without notice.



Canadian Display Systems Inc.

177 Westcreek Drive, Woodbridge, Ontario L4L 9N6
Ph: 905-265-7888, 1-800-895-5862 Fax: 905-265-7692

email cds1@on.aibn.com

www.canadiandisplayssystem.com