

# Eurostyle

## REFRIGERATED DELI CASE – RDD

MODELS: RDD 5338, RDD 5346, RDD 5358, RDD 5376, RDD 5392

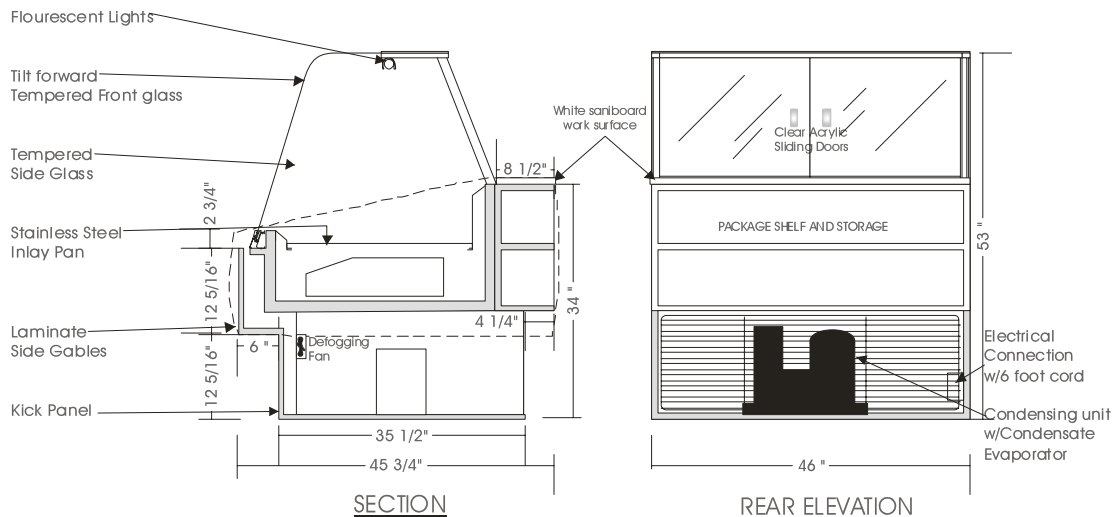

### SPECIFICATIONS

MODEL	DIMENSIONS	COMPRESSOR	ELECTRICAL	SHIPPING WT.
RDD 5338	38"L.X45 <sup>3</sup> / <sub>4</sub> "D.X53"H.	1/3 H.P.	115V/ 1/60HZ/ 9.0 AMP	475
RDD 5346	46"L.X45 <sup>3</sup> / <sub>4</sub> "D.X53"H.	1/3 H.P.	115V/ 1/60HZ/10.0 AMP	550
RDD 5358	58"L.X45 <sup>3</sup> / <sub>4</sub> "D.X53"H.	1/2 H.P.	115V/ 1/60HZ/12.0 AMP	760
RDD 5376	76"L.X45 <sup>3</sup> / <sub>4</sub> "D.X53"H.	1/2 H.P.	115V/ 1/60HZ/16.0 AMP	800
RDD 5392**	92"L.X45 <sup>3</sup> / <sub>4</sub> "D.X53"H.	3/4 H.P.	115V/ 1/60HZ/16.0 AMP	875

*Note: Add 3/4" each side for side gables.*

#### STANDARD FEATURES

1. Top light.
2. Tempered curved front glass, tilt forward and removable.
3. Front glass defogging system.
4. Clear satin anodized aluminum hinge and framework.
5. Exterior & interior laminate finish: Black
6. Self contained air cooled compressor w/ hot gas condensate evaporator pan.
7. Laminate covered side gables

#### OPTIONS

1. Shelf c/w light.
2. Plastic laminate exterior finish of choice.
3. Powder coated aluminum hinge and framework.
4. Custom units on request.
5. Remote condensing unit.

Operating temperature of 2° to 4° Celsius (37° to 40° F.) under normal store conditions of 24° Celsius (75° F.) with 50% relative humidity. Condensation on glass may occur under hot & humid conditions.  
**Product entering the display case must be 4° Celsius (40° F.) or lower.**

\*Due to constant improvements, specifications are subject to change without notice.

\*\* Direct electrical connection for Model RDD 5392



## Canadian Display Systems Inc.

177 Westcreek Drive, Woodbridge, Ontario L4L 9N6  
 Ph: 905-265-7888, 1-800-895-5862 Fax: 905-265-7692  
 email [cds1@on.aibn.com](mailto:cds1@on.aibn.com)  
[www.canadiandisplayystems.com](http://www.canadiandisplayystems.com)