

Eurostyle Counter Top

DROP-IN REFRIGERATED SELF SERVE DISPLAY CASE – CTRS 26

MODELS: CTRS 2638, CTRS 2648, CTRS 2660 CTRS 2676

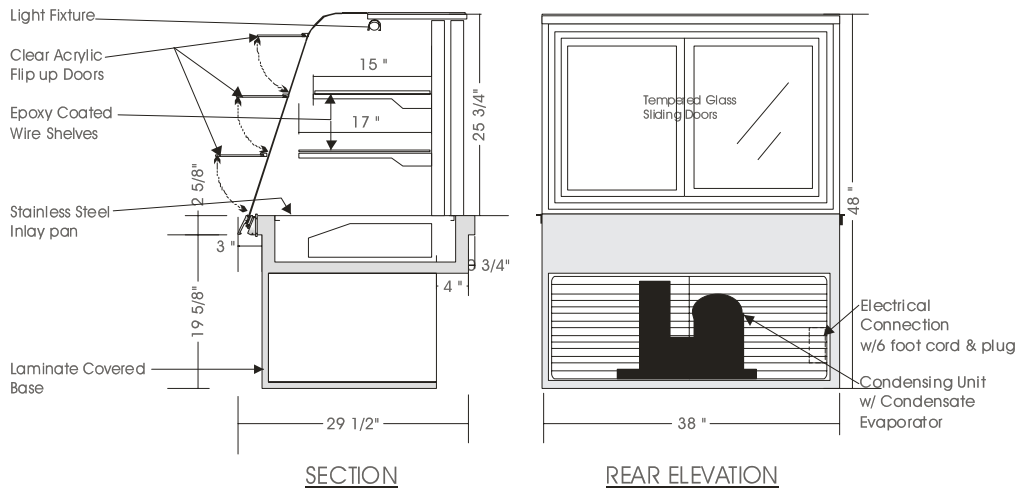

SPECIFICATIONS

MODEL	DIMENSIONS	COMPR.	ELECTRICAL	SHIPPING WT	CUTOUT SIZE
CTRS 2638	38"L.X30 1/4"D.X28 3/8"H.	1/3 H.P.	115V/1/60HZ/09.0 AMP.	270 lb.	38 1/4"L.X26 3/4"D.
CTRS 2648	48"L.X30 1/4"D.X28 3/8"H.	1/3 H.P.	115V/1/60HZ/10.0 AMP.	320 lb.	48 1/4"L.X26 3/4"D.
CTRS 2660	60"L.X30 1/4"D.X28 3/8"H.	1/2 H.P.	115V/1/60HZ/12.0 AMP.	450 lb.	60 1/4"L.X26 3/4"D.
CTRS 2676	76"L.X30 1/4"D.X28 3/8"H.	1/2 H.P.	115V/1/60HZ/13.0 AMP.	620 lb.	76 1/4"L.X26 3/4"D.

NOTE: 28 3/8" HT. From Counter Top - 48"HT. From Floor

STANDARD FEATURES

1. Top light.
2. Six clear acrylic flip doors.
3. Tempered curved glass top.
4. Tempered side glass – removable.
5. Clear satin anodized aluminum hinge and framework.
6. Self contained air cooled compressor w/hot gas condensate evaporator.
7. Exterior & interior laminate finish: Black.

OPTIONS

1. Shelf lights w/ electronic ballast.
2. Plastic laminate exterior finish of choice.
3. Powder coated or colour anodized hinge or framework.
4. Tempered glass shelves.
5. Remote condensing unit.

Operating temperature of 2° to 4° Celsius (37° to 40°F.) under normal store conditions of 24° Celsius (75°F.) with 50% relative humidity. Condensation on glass may occur under hot & humid conditions. Product entering the display case must be 4° Celsius (40°F.) or lower.

*Due to constant Improvements, specifications are subject to change without notice.



Canadian Display Systems Inc.

177 West Creek Drive, Woodbridge, Ontario L4L 9N6
Ph: 905-265-7888, 1-800-895-5862 Fax: 905-265-7692

email [cgs1@on.aibn.com](mailto:cds1@on.aibn.com)
www.canadiandisplayssystems.com