

# Concept

## REFRIGERATED MERCHANDISER – CRM 62

MODELS: CRM 6238, CRM 6248

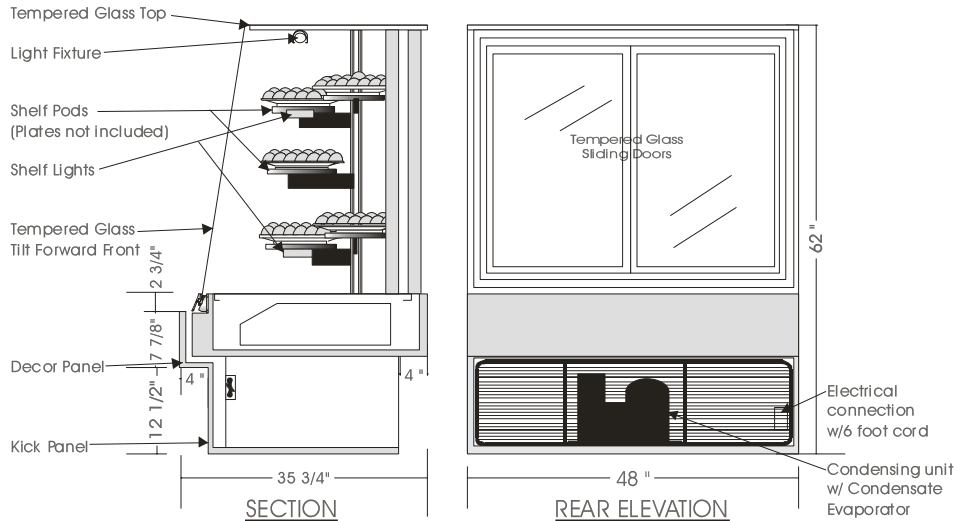

### SPECIFICATIONS

MODEL	DIMENSIONS	COMPRESSOR	ELECTRICAL	SHIPPING WT
CRM 6238	38"L.X35 <sup>3</sup> / <sub>4</sub> "D.X62"H.	1/2 H.P.	115/1/60 HZ/ 12.0 AMP	400lb.
CRM 6248	48"L.X35 <sup>3</sup> / <sub>4</sub> "D.X62"H.	1/2 H.P.	115/1/60 HZ/ 12.0 AMP	480 lb.

#### STANDARD FEATURES

1. Top light and two shelf lights.
2. Adjustable plate pads.
3. Black anodized aluminum hinge and framework.
4. Self contained air cooled compressor w/hot gas condensate evaporator pan.
5. Exterior & interior laminate finish: Black.

#### OPTIONS

1. Plastic laminate exterior finish of choice.
2. Powder coated or colour anodized hinge and framework.
3. Straight shelves.

Operating temperature of 2° to 4° Celsius (37° to 40°F.) under normal store conditions of 24° Celsius (75°F.) with 50% relative humidity. Condensation on glass may occur under hot & humid conditions. Product entering the display case must be 4° Celsius (40°F.) or lower.

\*Due to constant improvements, specifications are subject to change without notice.



## Canadian Display Systems Inc.

177 West Creek Drive, Woodbridge, Ontario L4L 9N6  
 Ph: 905-265-7888, 1-800-895-5862 Fax: 905-265-7692  
 email [cds1@on.aibn.com](mailto:cds1@on.aibn.com)  
[www.canadiandisplayystems.com](http://www.canadiandisplayystems.com)