

Cafeteria

WORK COUNTER – ESWU

MODELS: ESWU 5236, ESWU 5248, ESWU 5260, ESWU 5276, ESWU 5296

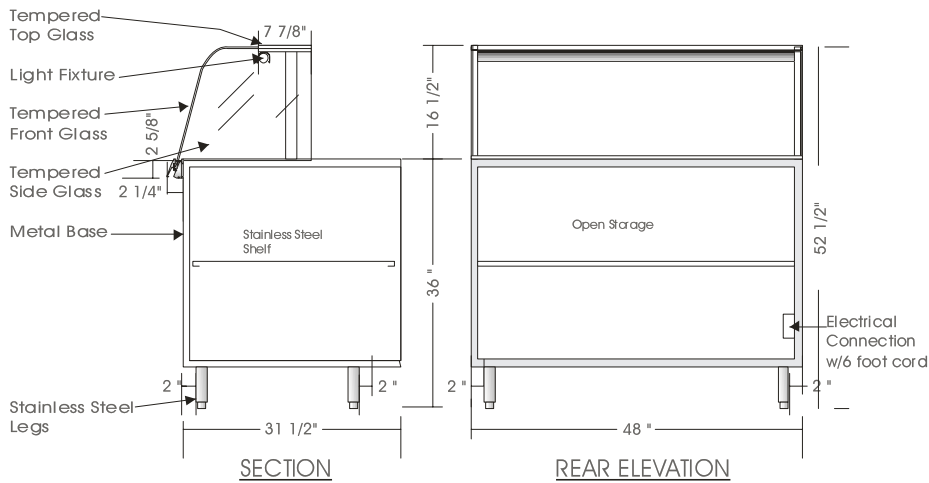

SPECIFICATIONS

MODEL	DIMENSIONS	ELECTRICAL	SHIPPING WT.
ESWU 5236	36"L.X34"D.X52 1/2"H.	115V/1/60 HZ/1.0 AMP	430 lb.
ESWU 5248	48"L.X34"D.X52 1/2"H.	115V/1/60 HZ/1.0 AMP	490 lb.
ESWU 5260	60"L.X34"D.X52 1/2"H.	115V/1/60 HZ/1.0 AMP	530 lb.
ESWU 5276	76"L.X34"D.X52 1/2"H.	115V/1/60 HZ/1.0 AMP	590 lb.
ESWU 5296	96"L.X34"D.X52 1/2"H.	115V/1/60 HZ/1.5 AMP	630 lb.

STANDARD FEATURES

1. Top light.
2. Painted exterior finish.
3. Stainless steel top and rear panels.
4. All metal construction.
5. Tempered curved front glass (Sneeze-guard), tilt forward and removable.
6. Clear satin anodized aluminum hinge and framework.

OPTIONS

1. White sani cutting board surface.
2. Powder coated or colour anodized hinge and framework.
3. Stainless steel front and sides.
4. Epoxy coated wire shelf.

*Due to constant improvements, specifications are subject to change without notice.



Canadian Display Systems Inc.

177 Westcreek Drive, Woodbridge, Ontario L4L 9N6
 Ph: 905-265-7888, 1-800-895-5862 Fax: 905-265-7692
 email cds1@on.aibn.com
www.canadiandisplayystems.com