

# Cafeteria

## ESCU COLD FOOD TABLE – ESCU

MODELS: ESCU 5236, ESCU 5248, ESCU 5260, ESCU 5276, ESCU 5296

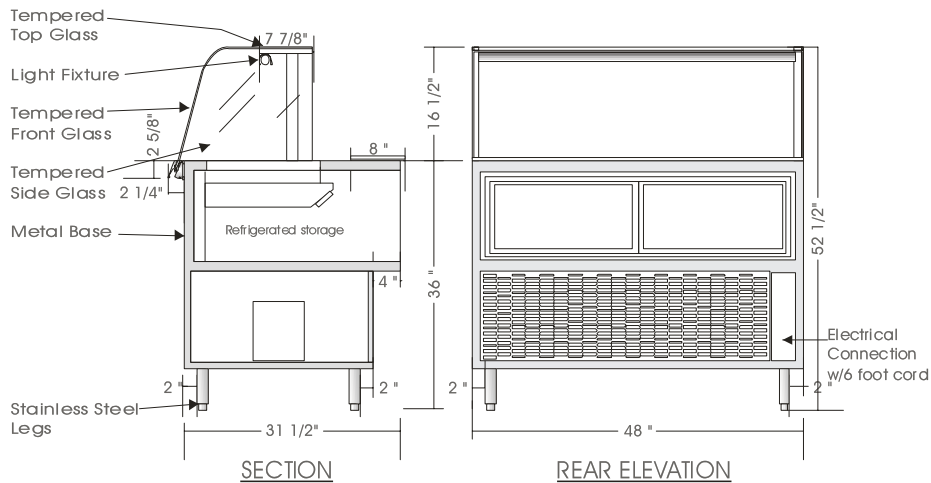

### SPECIFICATIONS

MODEL	DIMENSIONS	COMPRESSOR	ELECTRICAL	SHIPPING WT.
ESCU 5236	36"L.X34"D.X52 1/2"H.	1/4 H.P.	115V/1/60HZ/09.0 AMP	400 lb.
ESCU 5248	48"L.X34"D.X52 1/2"H.	1/3 H.P.	115V/1/60HZ/10.0 AMP	460 lb.
ESCU 5260	60"L.X34"D.X52 1/2"H.	1/3 H.P.	115V/1/60HZ/10.0 AMP	525 lb.
ESCU 5276	76"L.X34"D.X52 1/2"H.	1/2 H.P.	115V/1/60HZ/12.0 AMP	650 lb.
ESCU 5296	96"L.X34"D.X52 1/2"H.	1/2 H.P.	115V/1/60HZ/12.0 AMP	890 lb.

#### STANDARD FEATURES

1. Top light.
2. White sani cutting board surface.
3. Painted exterior finish.
4. Stainless steel top and rear panels.
5. All metal construction.
6. Tempered curved front glass (Sneeze-guard), tilt forward and removable.
7. Clear satin anodized aluminum hinge and framework.
8. Self contained air cooled compressor w/hot gas condensate evaporator pan.

#### OPTIONS

1. Powder coated or colour anodized hinge and framework.
2. Stainless steel front and sides.
3. Remote condensing unit.

Operating temperature of 2° to 4° Celsius (37° to 40°F.) under normal store conditions of 24° Celsius (75°F.) with 50% relative humidity. Product entering the display case must be 4° Celsius (40°F.) or lower.

\*Due to constant improvements, specifications are subject to change without notice.



## Canadian Display Systems Inc.

177 Westcreek Drive, Woodbridge, Ontario L4L 9N6  
Ph: 905-265-7888, 1-800-895-5862 Fax: 905-265-7692

email [cgs1@on.aibn.com](mailto:cds1@on.aibn.com)

[www.canadiandisplayssystems.com](http://www.canadiandisplayssystems.com)